

# PR65tt



## Energy efficiency

Uw (W/m<sup>2</sup>K): 1,1

## Categories achieved at test centre

Air permeability: HRN EN 12207:2017 - 4

Water tightness: HRN EN 12208:2001 - 7A

Wind resistance: HRN EN 12210:2016 - C5/B5

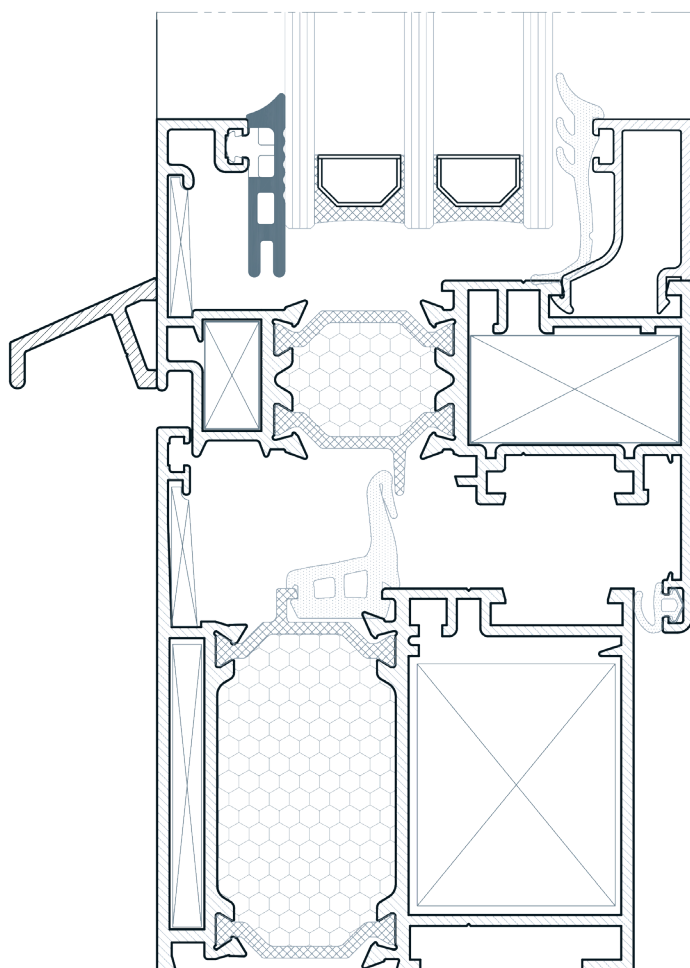

Glazing infill (mm):

21-50

Frame (mm):

65

Sash (mm):

73

Surface treatment options:

Colour powder coating Anodized

Extrusion alloy:

6060 T6

Polyamide strip length (mm):

24,5

Gaskets:

EPDM

EPDM+foam

