

PE85tt



Energy efficiency

Uw (W/m²K): 0,9

Categories achieved at test centre

Air permeability: HRN EN 12207:2017 - 4

Water tightness: HRN EN 12208:2001 - 9A

Wind resistance: HRN EN 12210:2016 - C4

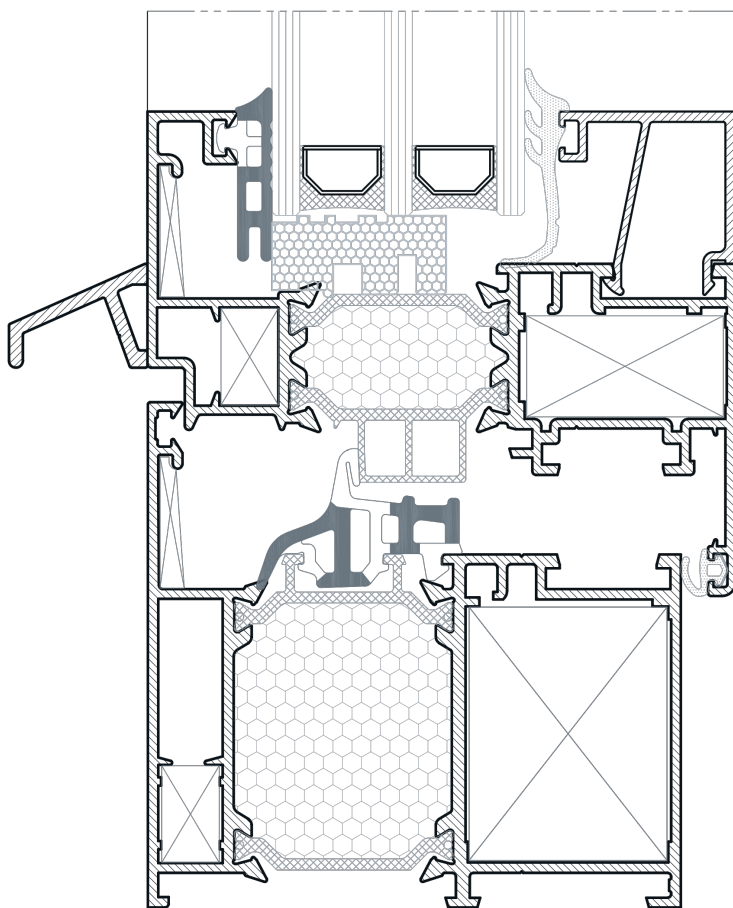

Glazing infill (mm):

30-63

Frame (mm):

77

Sash (mm):

85

Surface treatment options:

Colour powder coating Anodized

Extrusion alloy:

6060 T6

Polyamide strip length (mm):

31,6

Gaskets:

EPDM

EPDM+foam

